

# NEXUS

## AXLE & DRIVER UNIT DISASSEMBLY AND ASSEMBLY INSTRUCTIONS

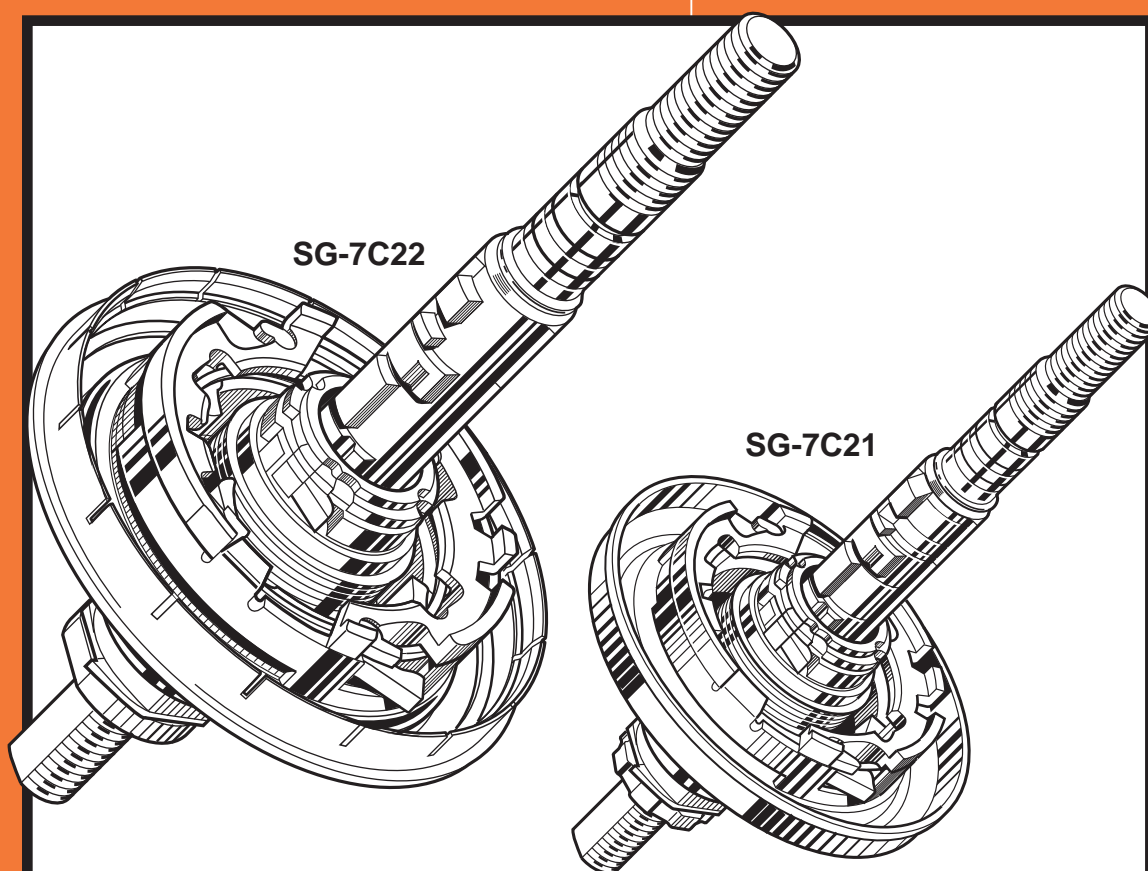

- This manual describes disassembly and assembly of the SG-7C22 / SG-7C21 axis & drive unit. The drawings correspond to those the instructions for SG-7C22
- Although some dimensions of the SG-7R40 / R41 / R42 axle & drive unit differ from those of the SG-7C22, the same disassembly and assembly instructions apply to both.
- Subject to technical changes for improvement.

SG-7C21  
SG-7C22



SG-7R40  
SG-7R41  
SG-7R42

Disassembly of axle & driver unit

Note: The drawings correspond to those of the SG-7C22.

1. Remove dust caps B and C from the driver (only for SG-7C22 / R42).

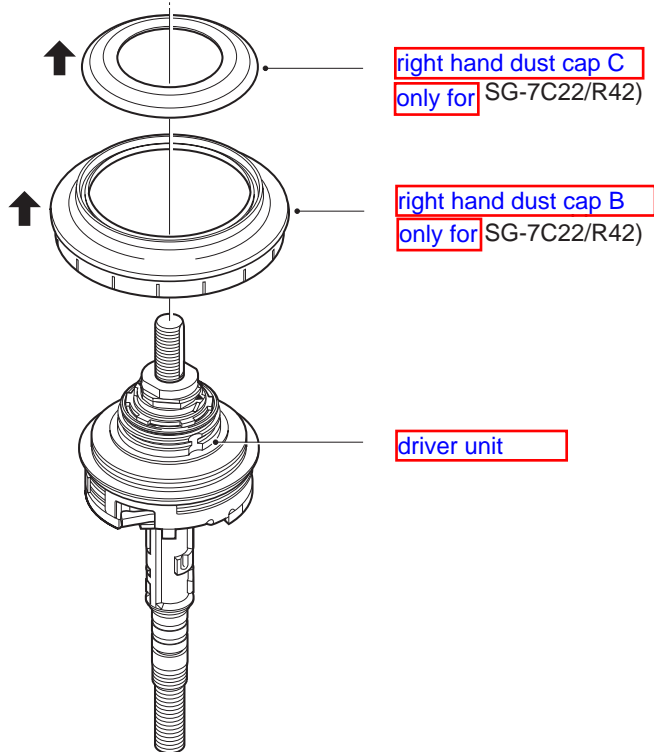

2. Clamp the flattened sides of the hub axle in a vice. Use TL-7S20 (for SG-7C22) or TL-7S40-A (for SG-7C21) to loosen the right hand lock nut.

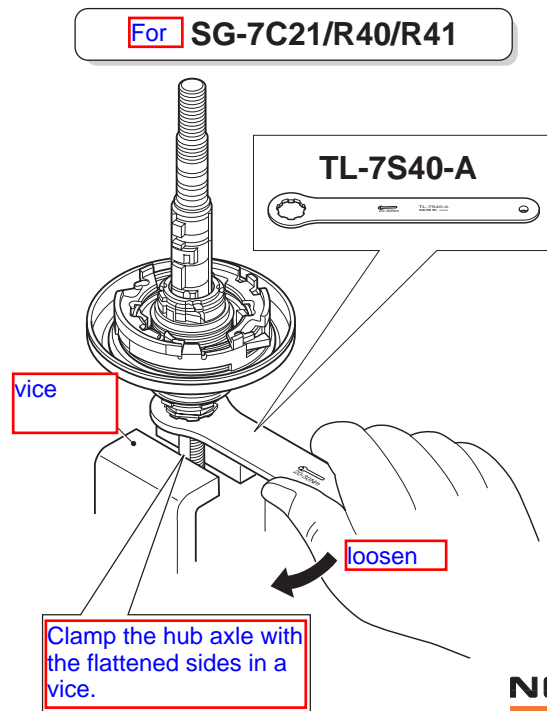
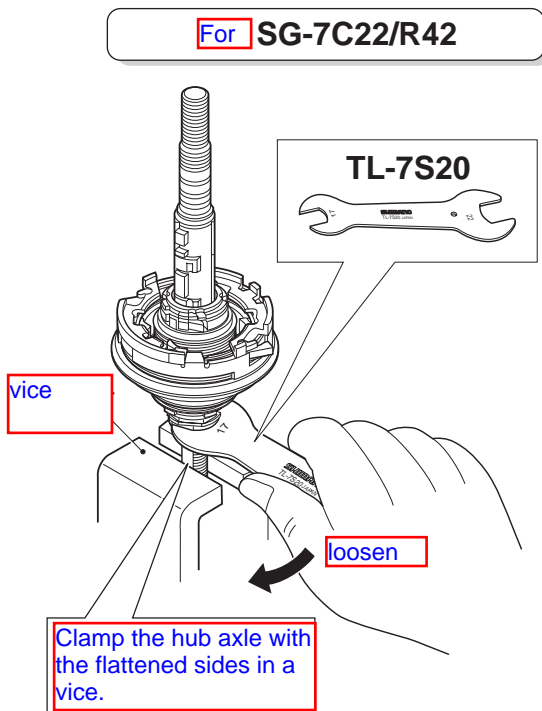



3. Turn axle and driver unit over, clamp the axle back into the vice. Then remove the right hand lock nut.

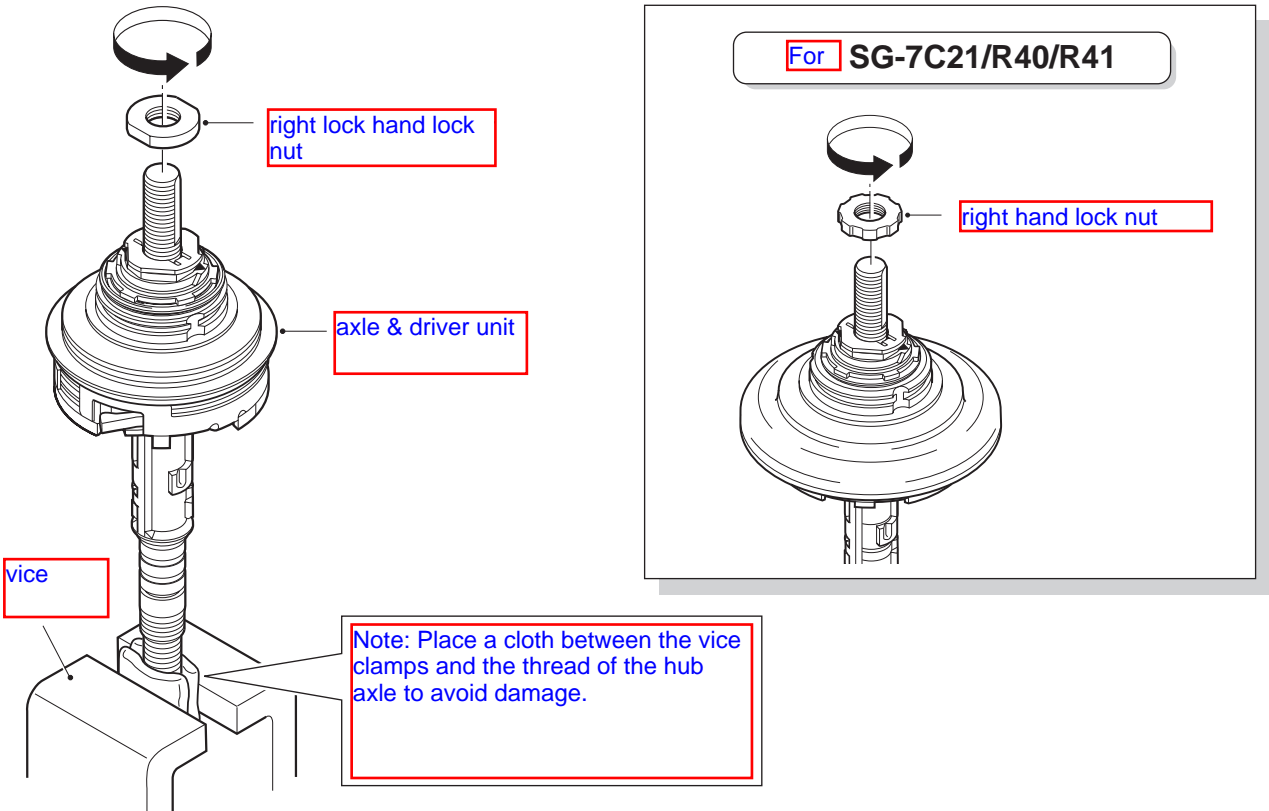

4. Remove the stop washer and cam washer.

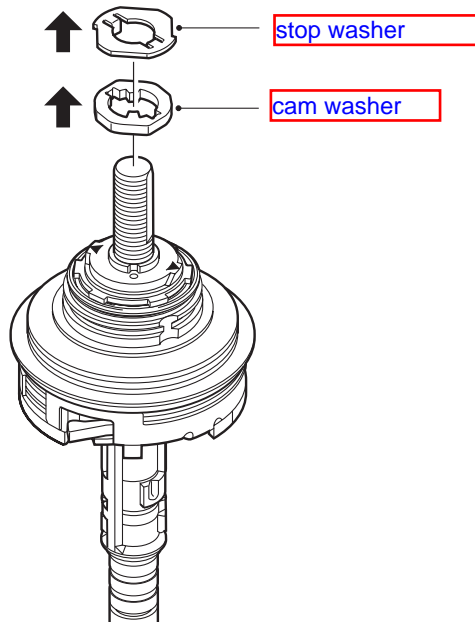

SG-7C21  
SG-7C22



SG-7R40  
SG-7R41  
SG-7R42

5. Remove the lock washer, driver plate and seals.

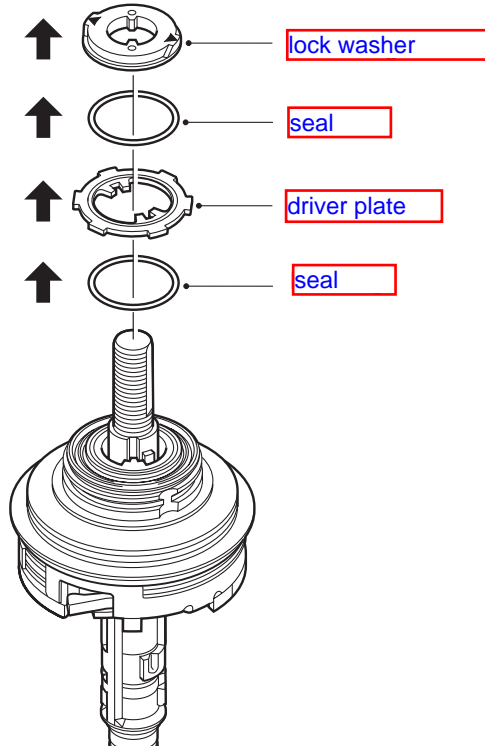

6. Take the axle & drive unit out of the vise, turn it over, and then push the gear down to remove the right hand cone seal, right hand cone, ball ring F, and driver assembly.

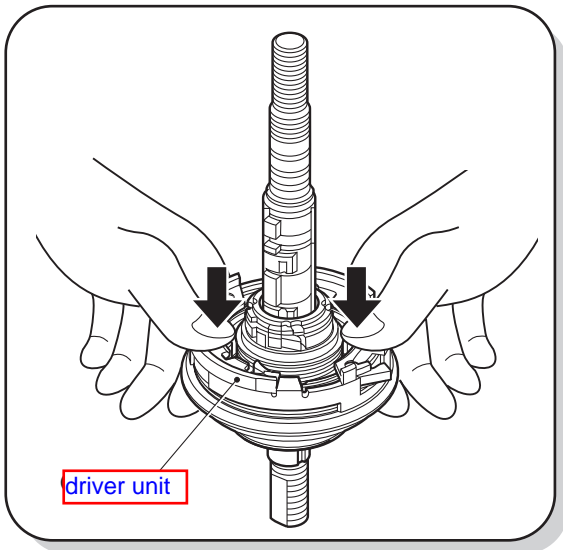
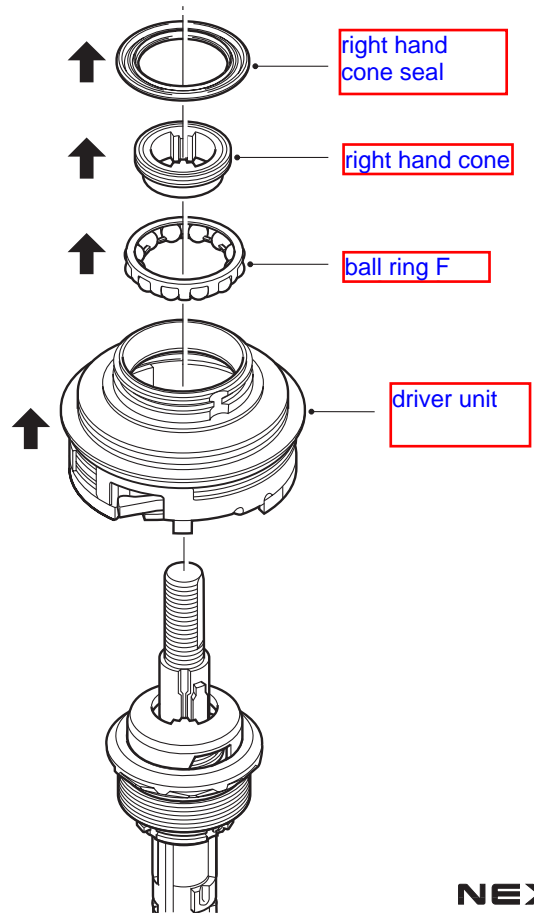



7. Remove the feed cam, gear shifting cam and return spring A.

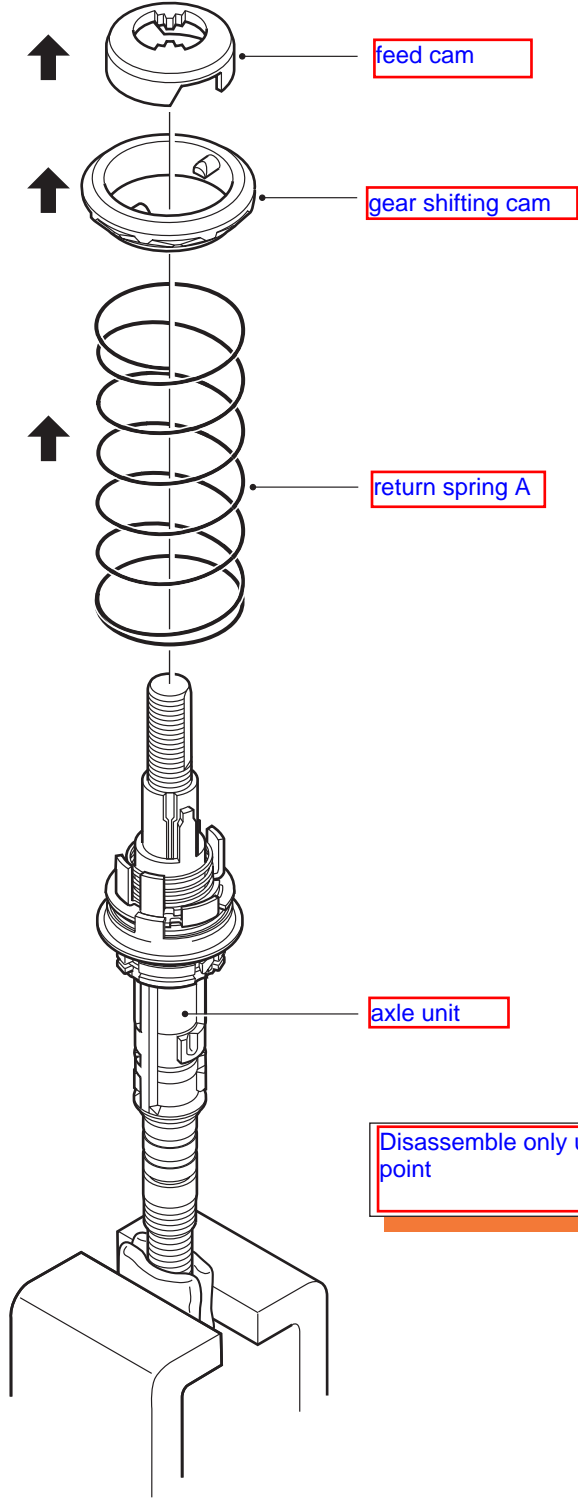

The disassembly of the axle & driver unit is now complete.

SG-7C21  
SG-7C22



SG-7R40  
SG-7R41  
SG-7R42

Axle & driver unit assembly

1. Secure the axle unit in a vice (as shown).

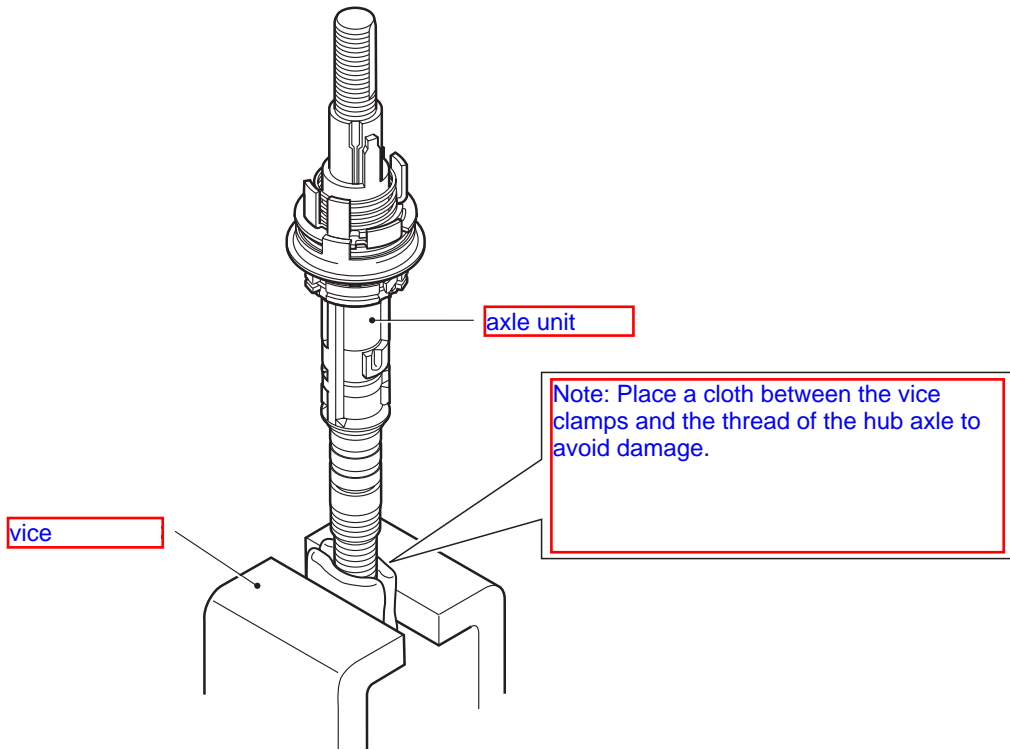

2. Place return spring A on return spring A cap.

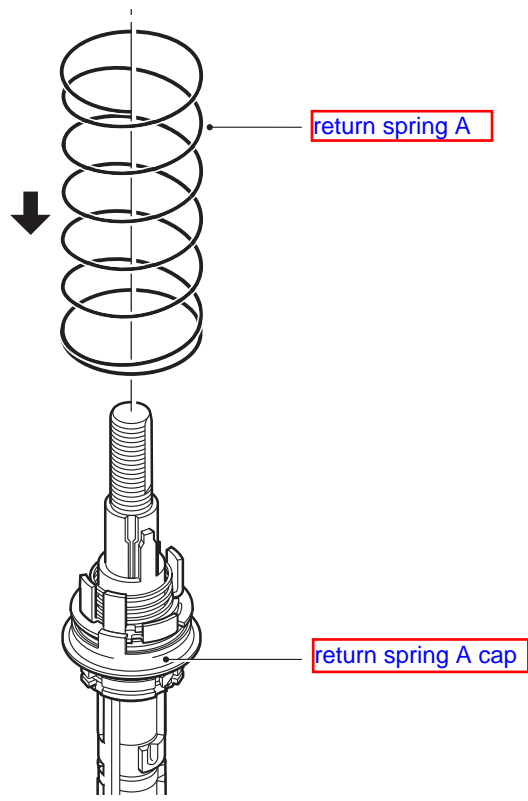



3. Press down return spring A with the gear shifting cam, place the lugs on the gear shifting cam in the cutouts in the spring D loader ring.

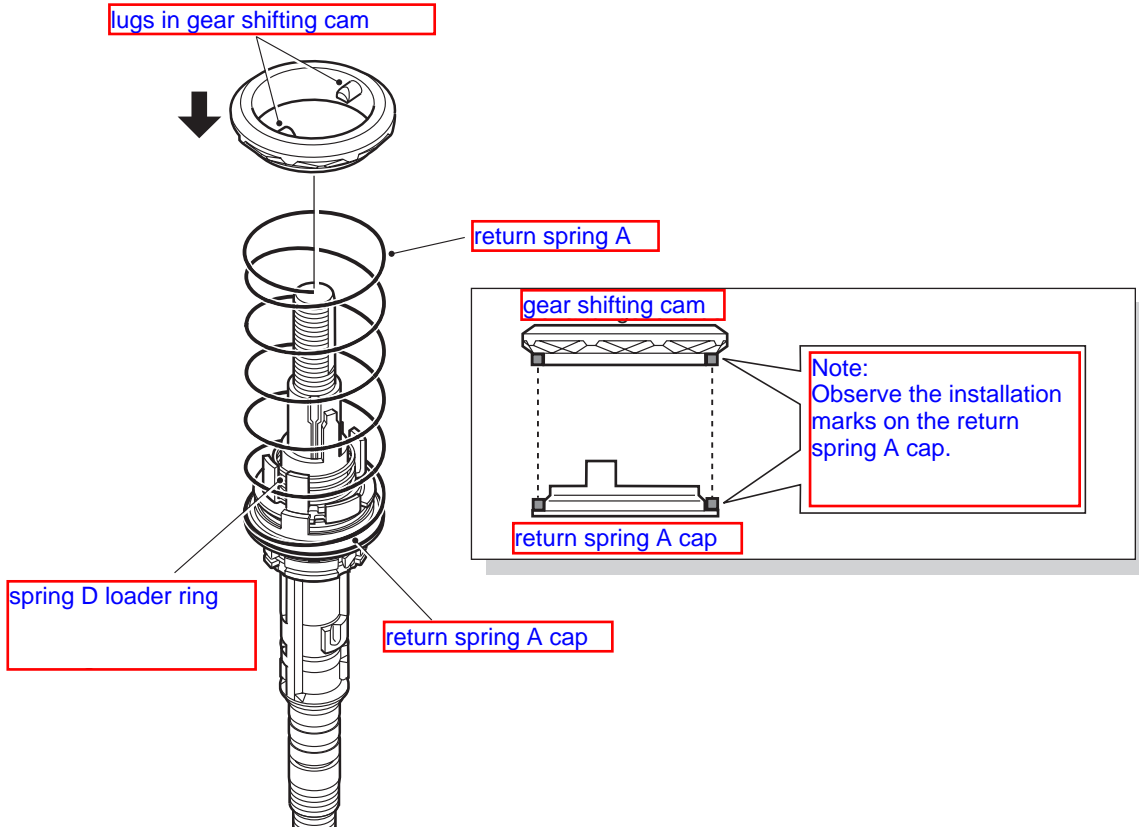

4. Align the lugs of the feed cam with the hub axle groove, then screw down the gear shifting cam counterclockwise until feed cam slides down and touches gear shifting cam.

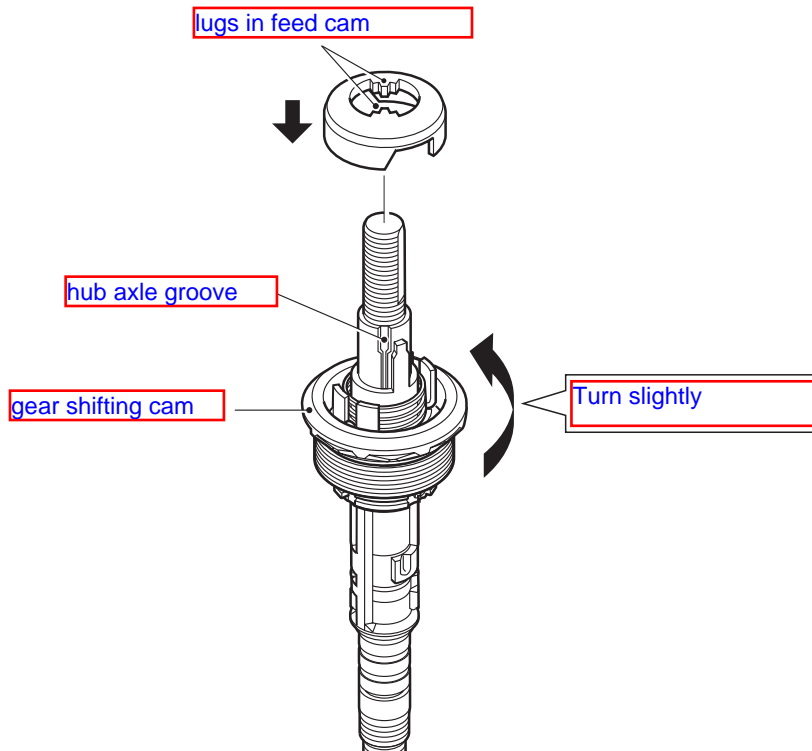

SG-7C21  
SG-7C22



SG-7R40  
SG-7R41  
SG-7R42

5. Install driver unit, insert ball retainer F.

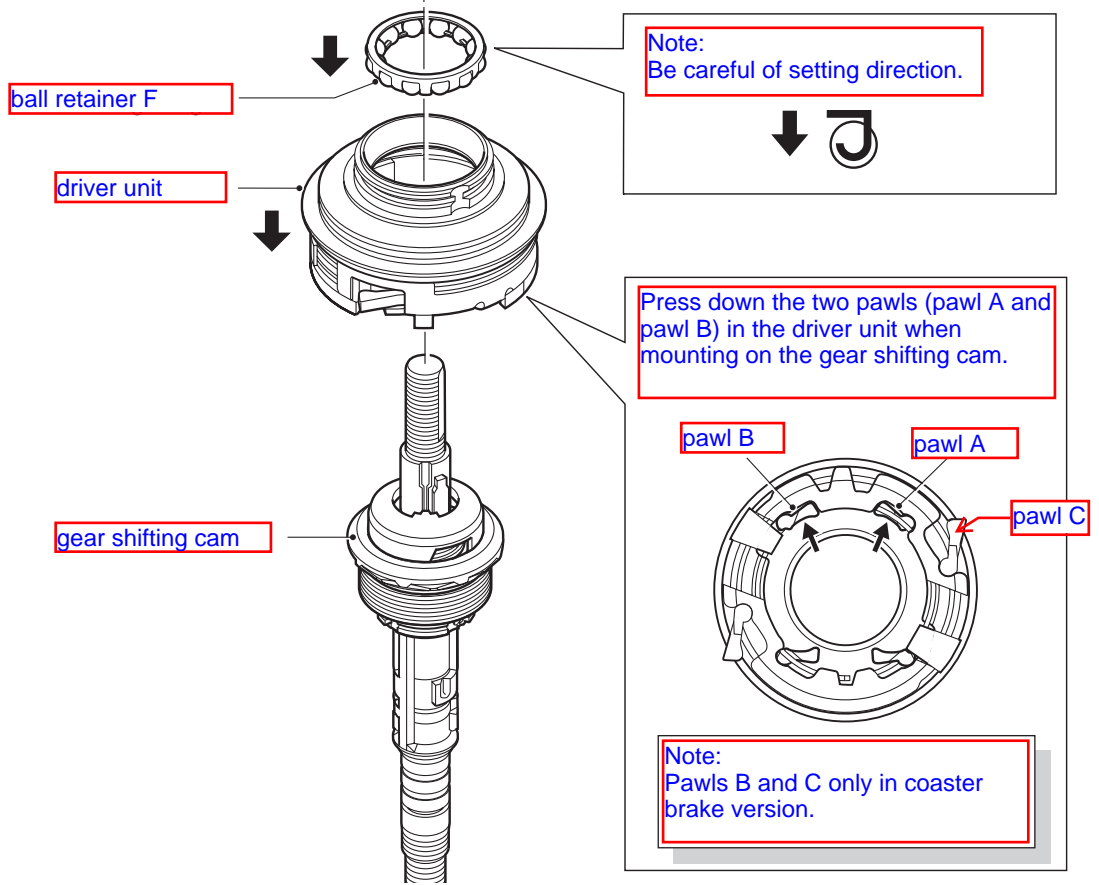

6. Align the lugs of the right hand cone with the groove on the hub axle. Use TL-7S40-B (right hand cone mounting tool) to push the right hand cone in as far as it will go.

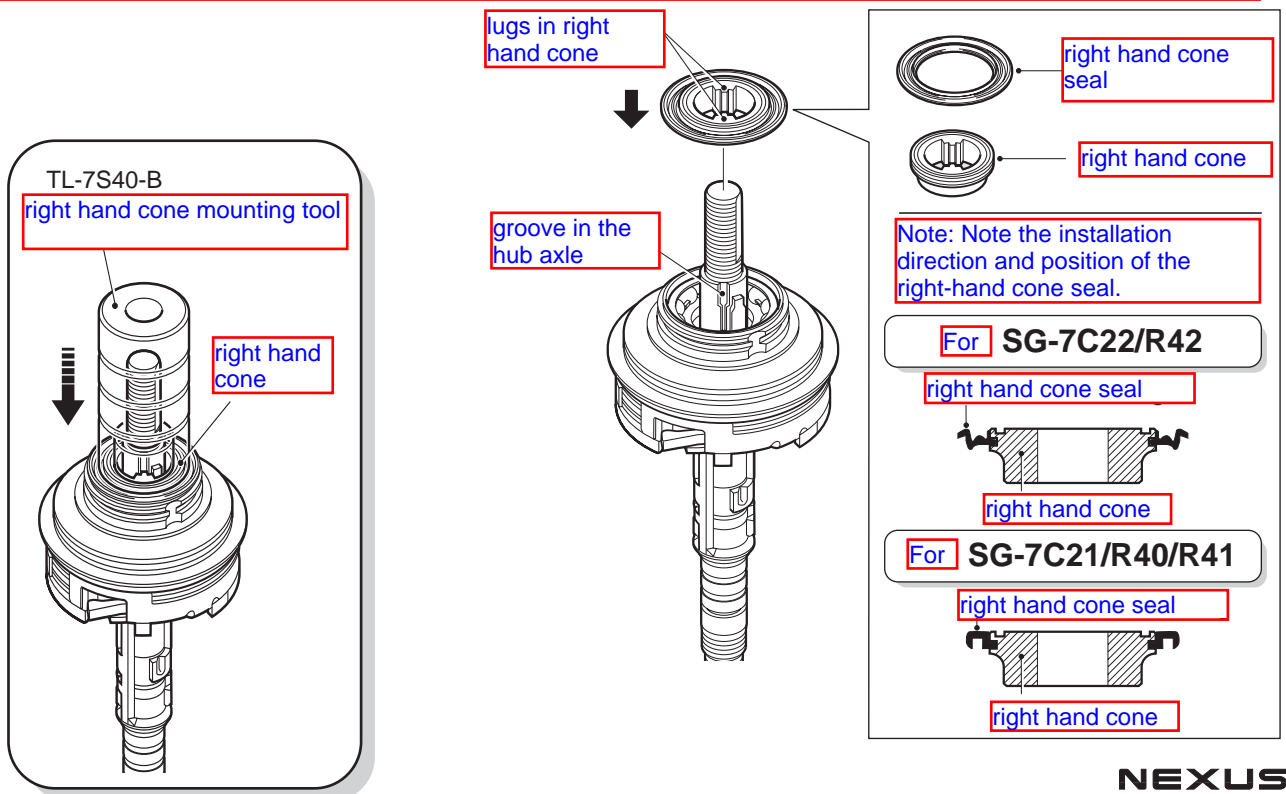





7. Place the seal on the right hand cone. Place the aligned driver plate on the shifter sleeve (lugs engage in cutouts).

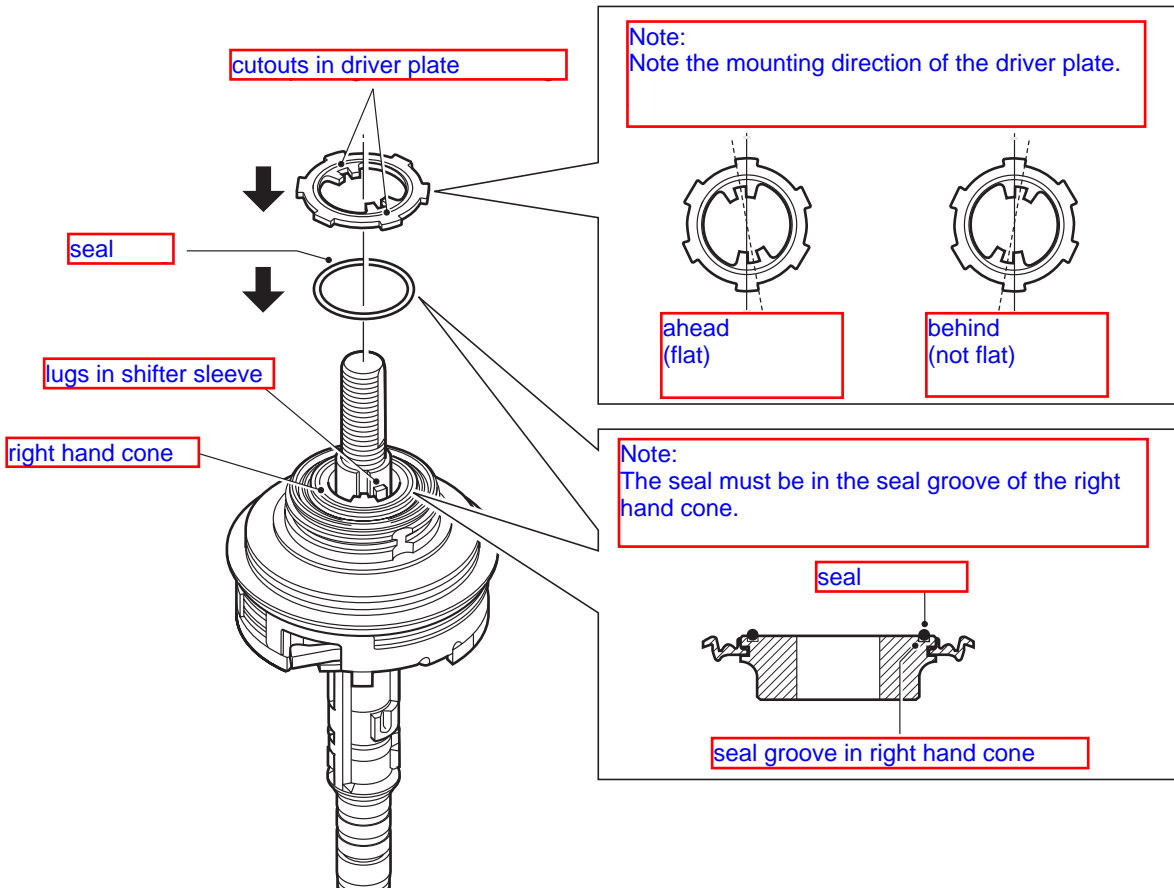

8. Place the seal on the driver plate, align the lugs on the lock washer with the hub axle groove.

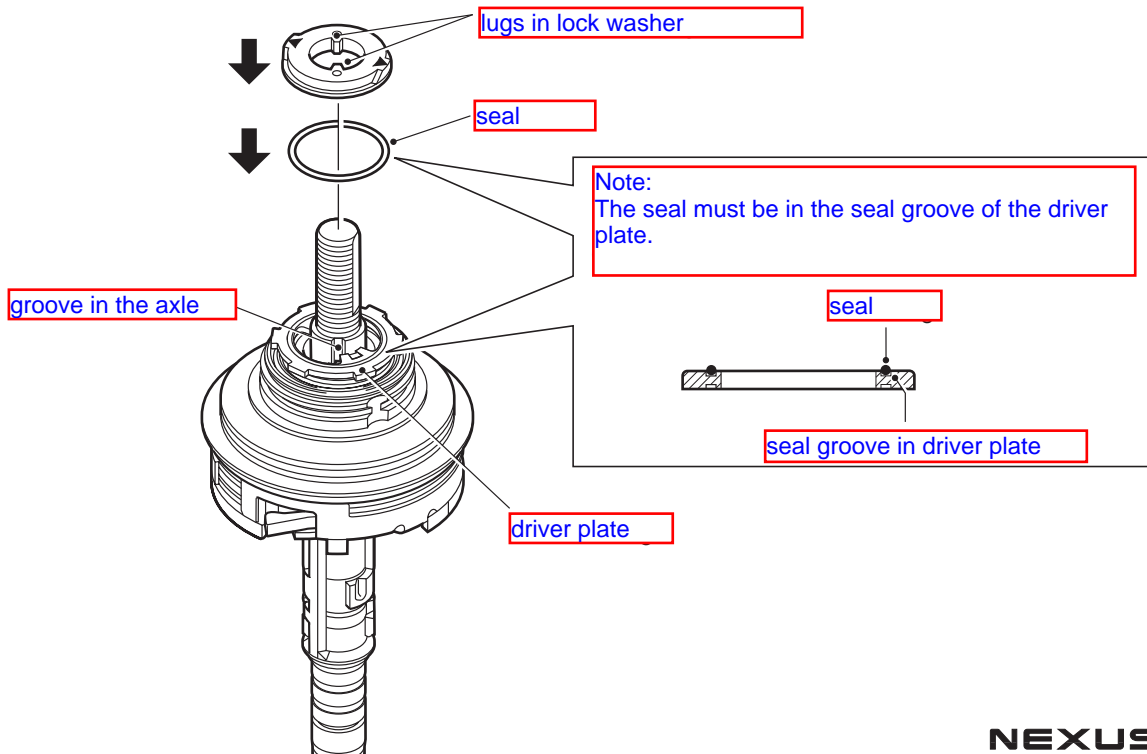

SG-7C21  
SG-7C22



SG-7R40  
SG-7R41  
SG-7R42

9. Put on the cam washer. Align the lugs with the hub axle groove.

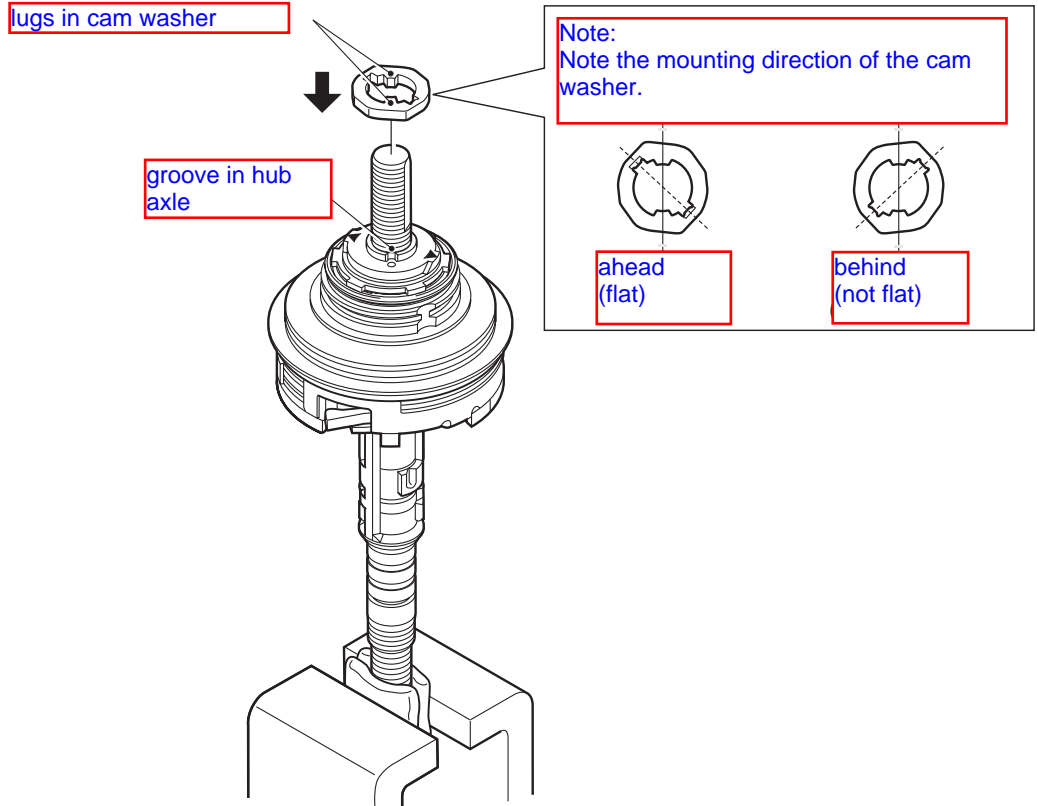

10. Align and insert the lugs on the stop washer with the cutouts in the cam washer.

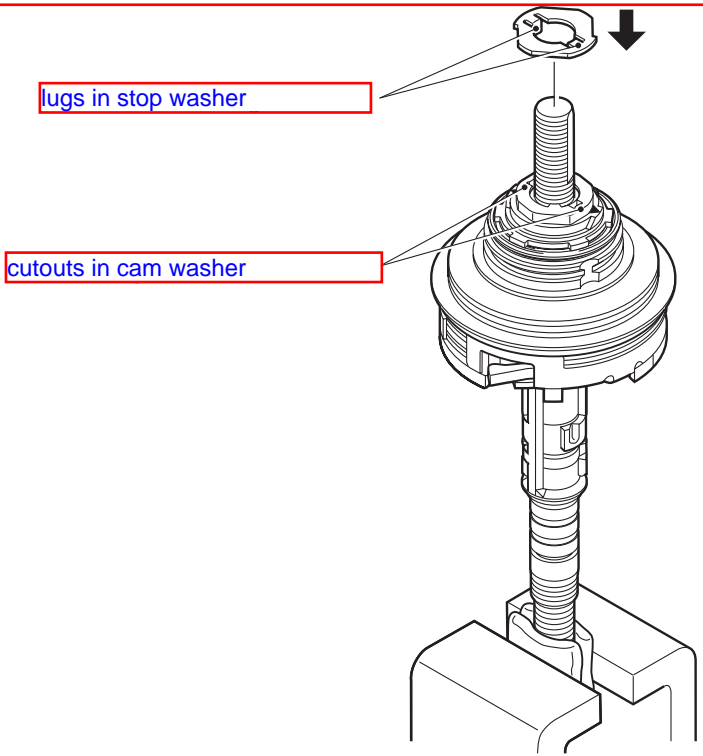

**SG-7R40  
SG-7R41  
SG-7R42**



**SG-7C21  
SG-7C22**



11. Screw the right hand lock nut onto the hub axle.

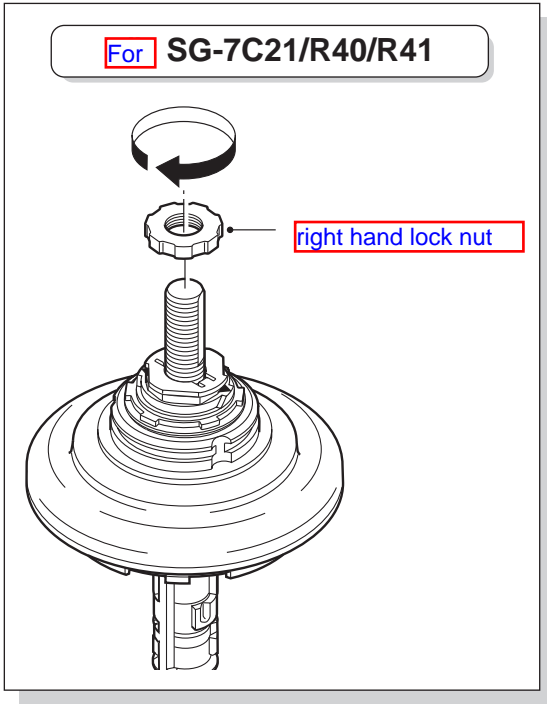
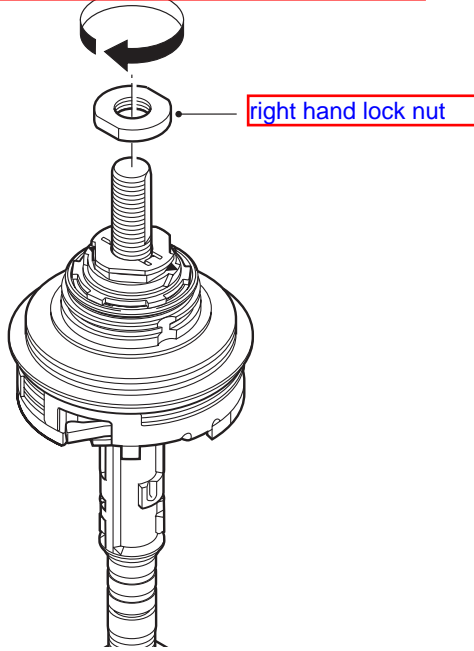

12. Remove the axle and driver unit from the vice. Then turn the axle and drive unit over, clamp them with flattened sides of the hub axle in a vice. Tighten the lock nut with TL-7S20 (for SG-7C22 / R42) or TL-7S40-A (for SG-7C21 / R40 / R41).

For **SG-7C22/R42**

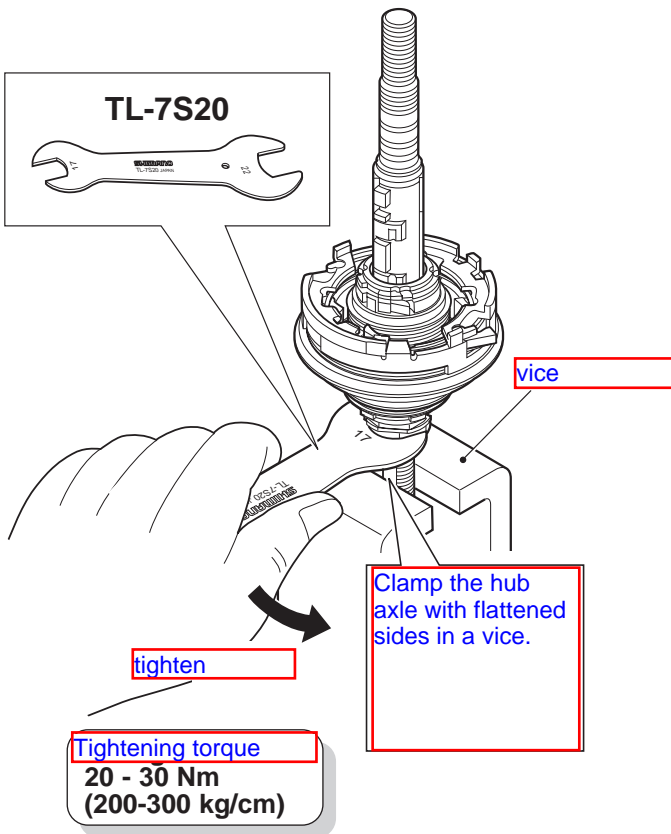

For **SG-7C21/R40/R41**

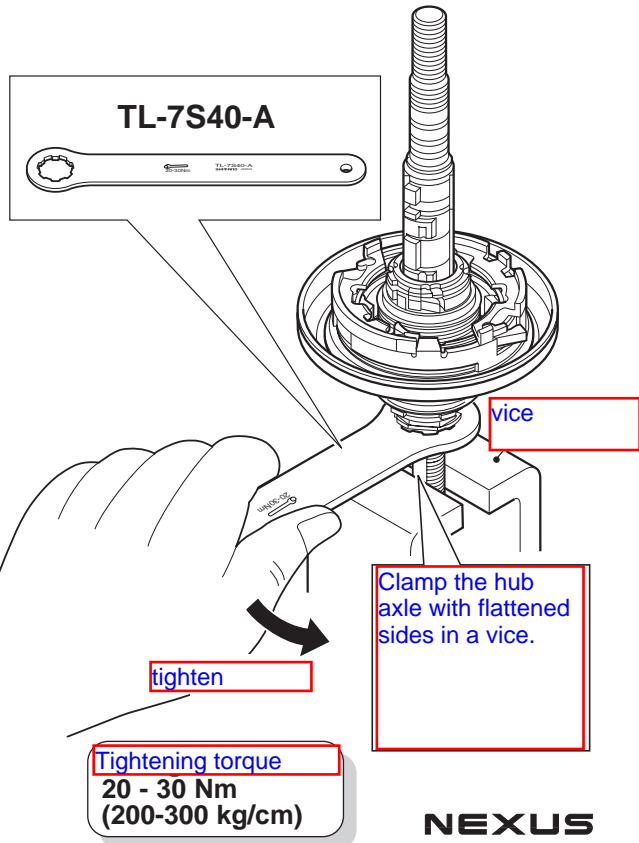

SG-7C21  
SG-7C22

SHIMANO  
INTER<sup>7</sup>

SHIMANO  
INTER<sup>M</sup>



SG-7R40  
SG-7R41  
SG-7R42

13. Mount the remaining parts of the axle and drive unit on the hub shell. Press the right hand dust cap B firmly onto the drive side of the hub shell. Fit the right hand dust cap C, then fit the sprocket.

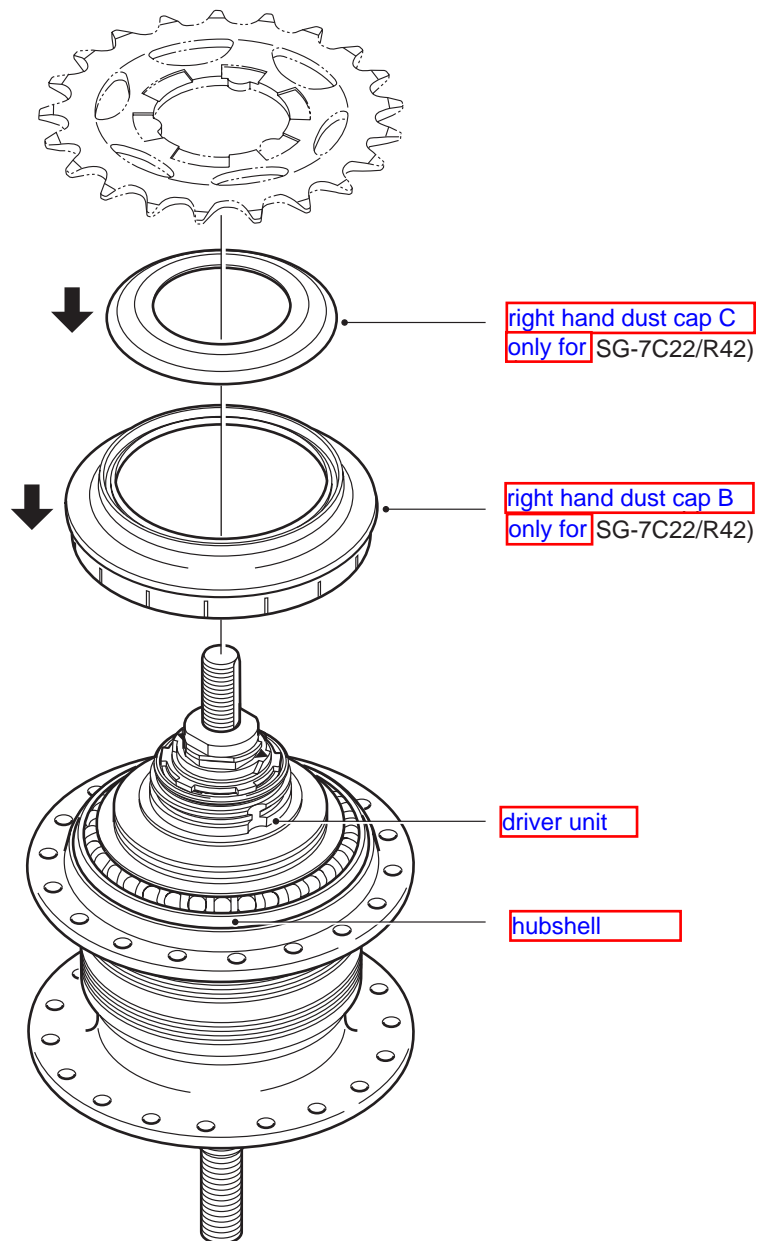

The assembly of the axle & driver unit is now complete.